

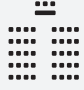





# Sokha Angkor Conference Facilities

Room Type	Measurement (Meter)	Area (Square Meter)	Height (Meter)	 Theatre	 Classroom	 U-shape	 Boardroom	 Reception	 Banquet	 Buffet
Ballroom I	13.0 x 9.6	124.8	6.3	133	53	50	40	133	70	70
Ballroom II	13.0 x 8.5	110.5	6.3	133	53	50	40	133	70	70
Ballroom III	13.0 x 8.4	109.2	6.3	133	53	50	40	133	70	70
Grand Ballroom	13.0 x 26.3	344.5	6.3	400	160	150	120	400	210	210
Pre-Function Lounge	26.5 x 7.0	185.5	4.7	120	60	50	40	120	120	120
Apsara I	8.2 x 8.12	66.58	2.6	50	25	20	15	70	45	45
Apsara II	12.6 x 8.3	104.58	2.55	100	50	40	30	115	90	90
Angkor Boardroom	8.0 x 5.75	46	2.9	20	10	10	8	50	30	30
Poolside Area	31.57 x 47.97	1,514.41	-	-	-	-	-	350	270	250
Open Terrace	10 x 4.7	47	-	-	-	-	-	50	-	-

# Floor Plan

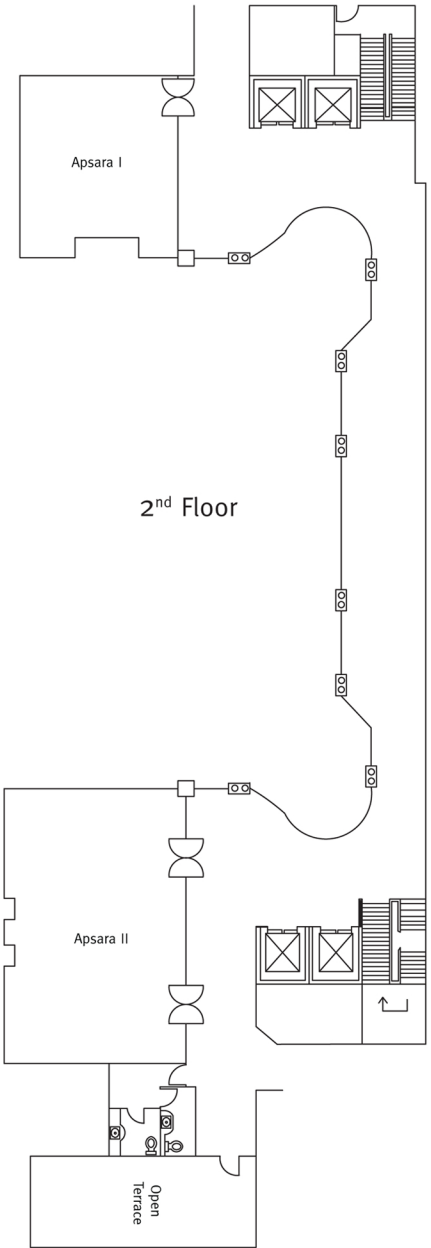
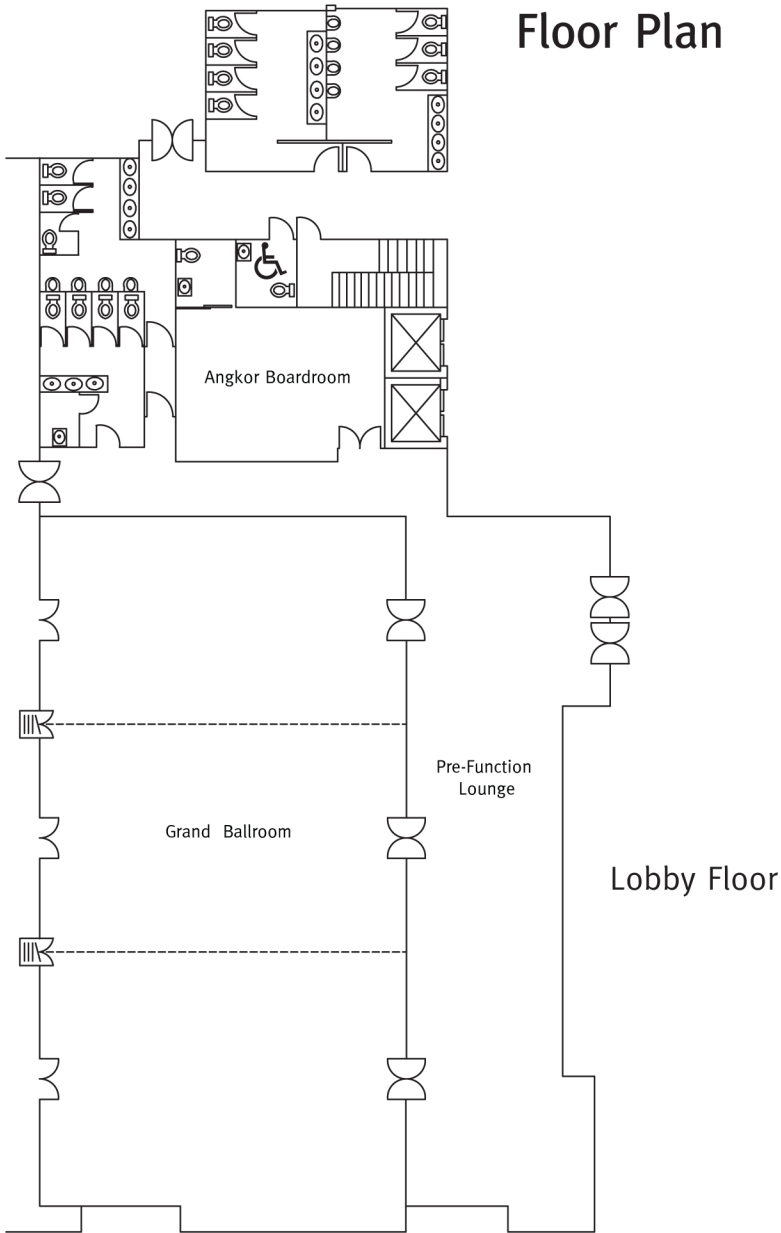

Sokha Angkor Resort | Siem Reap | Cambodia

E: [reservations.sr@sokhahotels.com](mailto:reservations.sr@sokhahotels.com)

T: +855 63 969 999 | F: +855 63 969 998

[www.sokhahotels.com](http://www.sokhahotels.com)